

**1 AREA 1 FLOOR PLAN - EQUIPMENT CONNECTIONS**  
1/8" = 1'-0"

(APPLY TO THIS SHEET ONLY)

1. ALL PENETRATIONS THROUGH CONSTRUCTION BOUNDARIES OF ROOMS PROTECTED BY CLEAN AGENT FIRE SUPPRESSION SYSTEMS SHALL BE SEALED GAS-TIGHT BY THE CONTRACTOR RESPONSIBLE FOR THE PENETRATIONS PRIOR TO FIRE SUPPRESSION SYSTEM ACCEPTANCE TEST. COORDINATE WITH ALL AFFECTED TRADES. IF THE SYSTEM DOES NOT PASS THE TEST, RESEAL PENETRATIONS AND RETEST UNTIL SYSTEM PASSES. CONTRACTOR(S) RESPONSIBLE FOR LEAKING PENETRATION(S) SHALL BEAR ANY COSTS ASSOCIATED WITH RETESTING THE FIRE SUPPRESSION SYSTEM.

(APPLY TO THIS SHEET ONLY)

- ① PROVIDE EMPTY J-BOX FOR MECHANICAL CONTROLS. COORDINATE ACTUAL LOCATION AND NUMBER OF BOXES WITH MECHANICAL CONTRACTOR.
- ② MOUNT BELOW ACCESS FLOORING.

# SAMPSON COUNTY 911 & ES FACILITIES

CLINTON,  
NORTH CAROLINA

# CONSTRUCTION DOCUMENTS

# AREA 1 EQUIPMENT CONNECTIONS PLAN

DATE	12.04.202	
PROJECT NO	2000	
REVISIONS		
NUM.	DATE	DESCRIPTION:

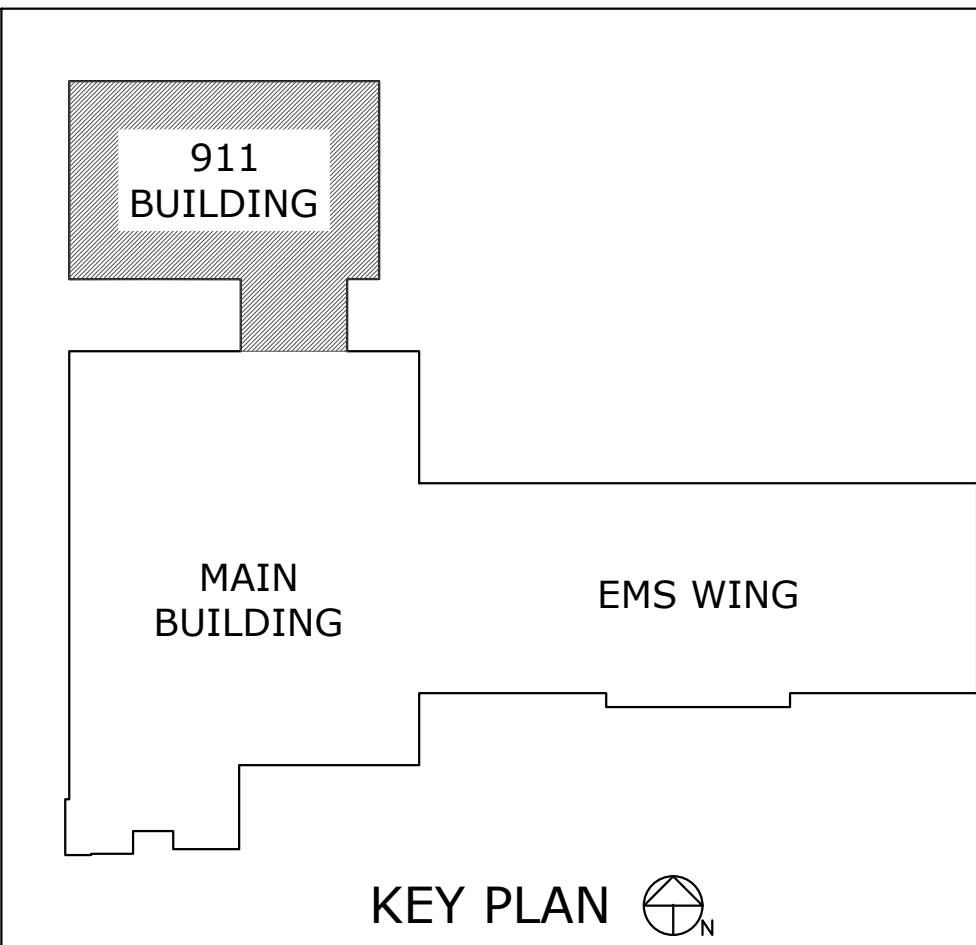

THIS DRAWING IS THE PROPERTY OF ADW ARCHITECTS, P.A. AND SHALL NOT BE REPRODUCED OR COPIED IN WHOLE OR IN PART. IT SHALL NOT BE USED ON ANY OTHER PROJECT OR GIVEN TO ANY OTHER COMPANY OR AGENCY WITHOUT THE CONSENT OF ADW ARCHITECTS, P.A.

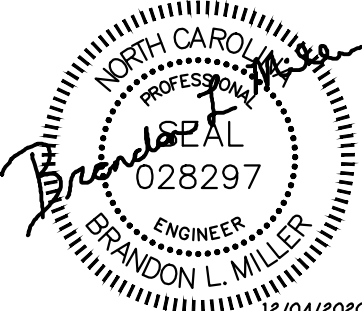

SEAL 12/04/2020

SHEET NUMBER E301